

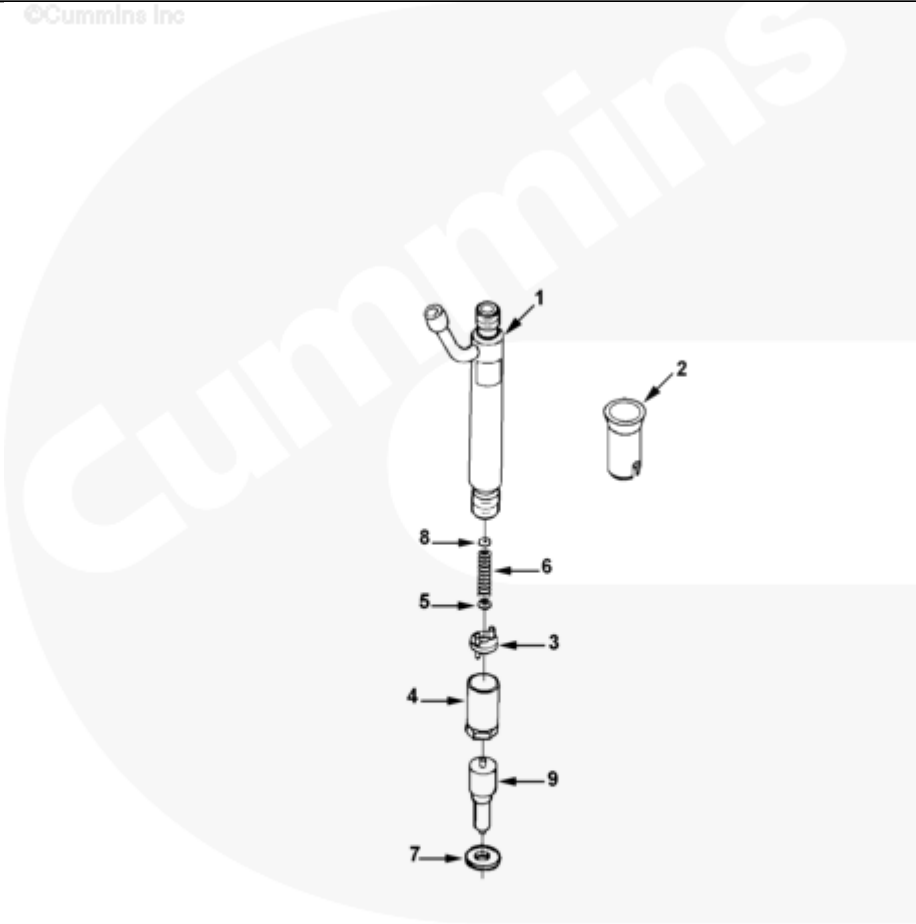

Parts Catalog - Option Detail

Electronic Parts Catalog - Option Detail				
Option	Group	Graphic	Film Card	Date
PP2833	06.01.1	fi940ga	Z	27-APR-00
Engines	6C8.3, C GAS PLUS CM556, G8.3, G8.3 CM558, GTA8.3 CM558, ISC CM2150, ISC CM554, ISC CM850, ISC8.3 CM2250, ISC8.3 G CM2180 C101, ISL CM2150, ISL CM554, ISL CM850, ISL G CM2180, ISL8.9 CM2150 L110, ISL8.9 CM2880 L112, ISL9 CM2150 SN, ISL9 CM2250, ISL9 CM2350 L101, ISL9 CM2350 L111, ISLE4 CM850, L GAS PLUS CM556, L8.9, L8.9 L121, L8.9G CMOH2.0 L125B, L9 CM2350 L116B, L9 CM2350 L119B, L9 CM2350 L120C, L9 CM2350 L123B, L9.3 L105, L9.5 L117, L9N CM2380 L124B, QSC8.3 CM2250, QSC8.3 CM2880 C102, QSC8.3 CM554, QSC8.3 CM850(CM2850), QSL9 CM2250, QSL9 CM2250 L115, QSL9 CM2350 L102, QSL9 CM2350 L107, QSL9 CM2350 L118, QSL9 CM2350 L122, QSL9 CM554, QSL9 CM850(CM2850), QSL9 G CM558, QSL9 M CM2250 L106, QSL9.3 CM2880 L113			



fi940ga

Cart	Ref No	Part Number	Part Description	Required	Remarks
View My Cart					
		PP2833	Fuel Injector		MR - INJECTOR, FUEL...(More)
					Performance Parts for:
					6CTA8.3 Litre
					Engine Family: C Series
					Reference CPL#: 1845
					Certified By: EPA,CARB
					Cylinders: 6
					Exhaust Manifold Type: Dry
					Aspiration: Jacket Water
					Aftercooled
					Engine Certification Status:
					Approved
					Fuel Pump Model: Bosch P3000
					Certification Year: 1997
					High Pressure Fuel Line ID
					(mm): 1.8
					Unique Characteristics: With
					Edge Filter Injectors
					Catalytic Converter Required:
					No
					Cylinder Head Valve Material:
					Premium
					Base Turbocharger ID17:
					3533132; 3535617; 3535787;
					3538422
<input type="checkbox"/>		3802648	Injector	6	Recon Equivalent 3802648 RX
	1	3926787	Injector	1	Sold In Higher Level Assy/Kit

<input type="checkbox"/>	2	3909886	Injector Seal	1	
<input type="checkbox"/>	3	3905154	Intermediate Disc	1	
<input type="checkbox"/>	4	3905155	Injector Nozzle Retainer	1	
<input type="checkbox"/>	5	3915118	Injector Spindle	1	
<input type="checkbox"/>	6	3915119	Compression Spring	1	
<input type="checkbox"/>	7	3923261	Injector Seal	1	
8					See Group 06.01.2
<input type="checkbox"/>	9	3919721	Injector Nozzle	1	

© 2019 Cummins Inc., Box 3005, Columbus, IN 47202-3005 U.S.A.
Terms of Use and Disclaimers | Recommended System Requirements
Need Assistance? Please click on the Contact Us button in the top right corner of any page.